

The ambient lighting in the boutique is provided by two light structures running the length of the space and equipped with indirect luminaires for the lighting of the shallow ceiling vaults. Three runs of track are recessed in the ceiling parallel to the light structures and take spotlights for accent lighting on shelves and displays. Two groups of six directional spotlights provide accent lighting in the shop-window.

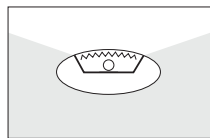

Light structure with indirect luminaires for fluorescent lamps.

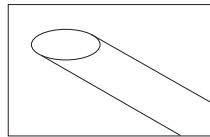
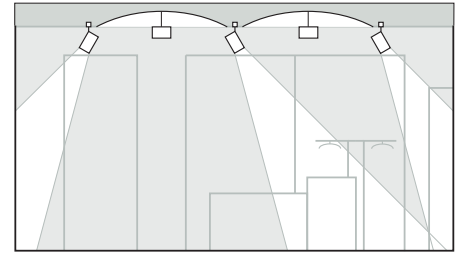
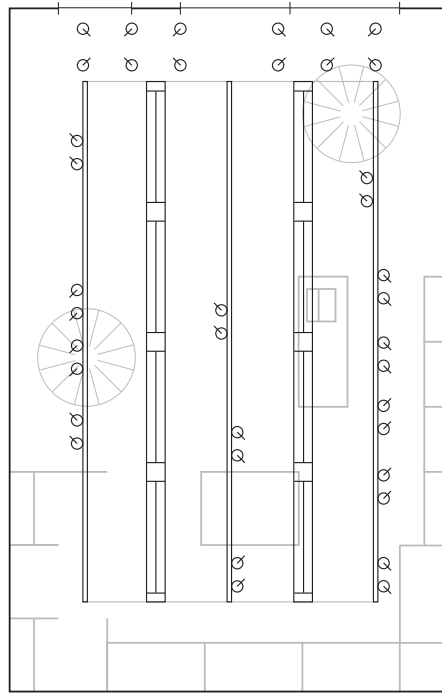
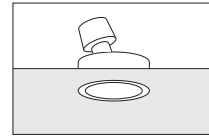

Directional spotlight for low-voltage halogen lamps.

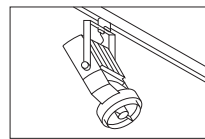
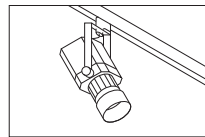
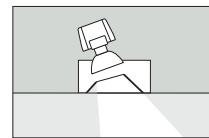

Track-mounted spotlights.

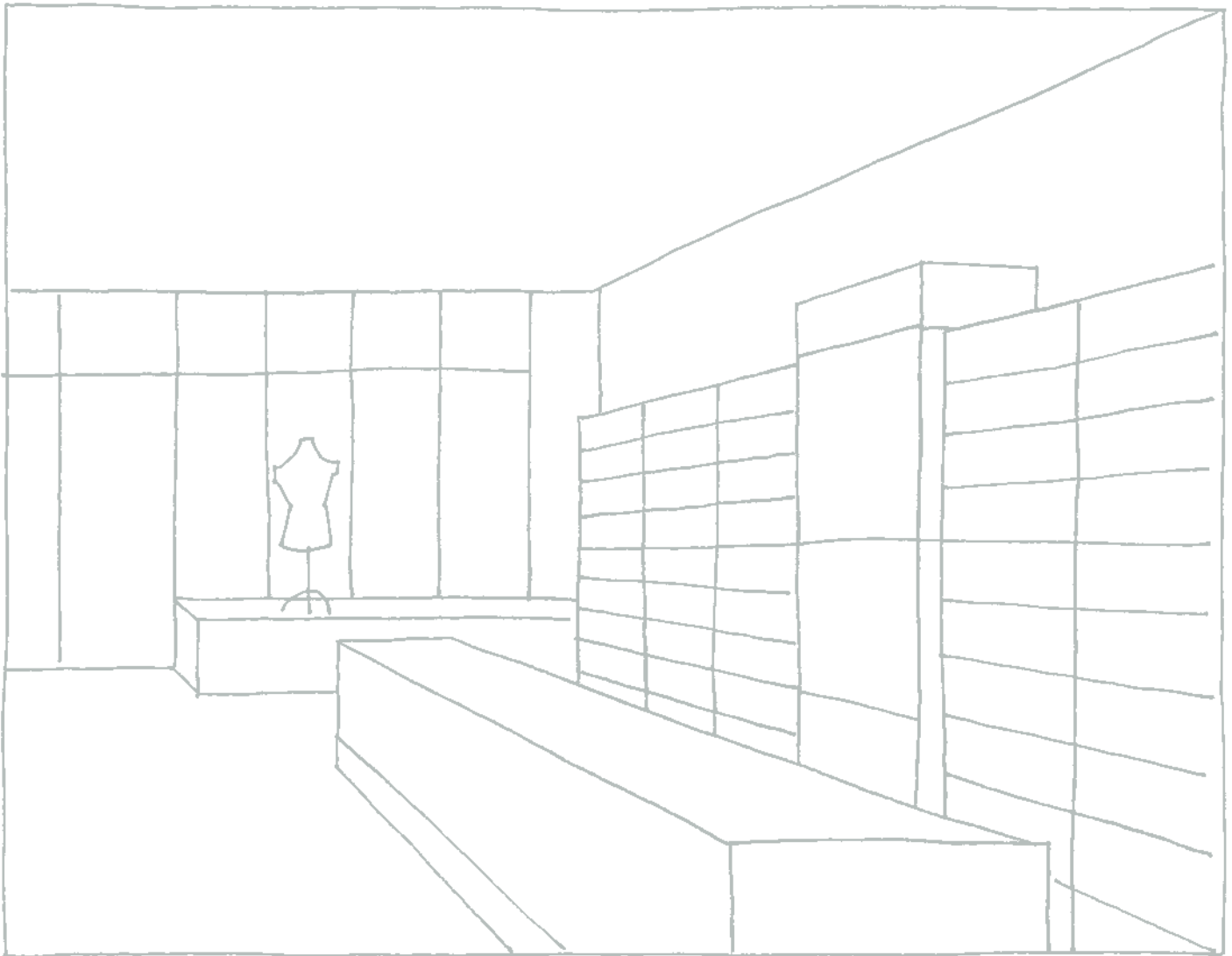

#### 4.18 Sales areas, counters

Sales areas where customers are served by staff at counters are mainly found in retail outlets where customers require consultation, e.g. a jeweller's shop. The counter itself creates a dividing element in the space, the resulting areas each requiring their own lighting. The main circulation area requires general lighting. Shelves or showcases require vertical display lighting, the counter itself glare-free horizontal lighting.